

Campos

search for property MAL-077932



PORTA MONDIAL®

Your home. Our passion.

Exclusive newly-built finca with pool and wonderful views between Campos and Santanyi

constructed area: 534 m²
plot area: 16.886 m²
bedrooms: 4
bathrooms: 4
sea view: -

energy certificate: in process

price: € 3,950,000.-



Campos

search for property MAL-077932



Details:

This wonderful, newly-built finca stands on a plot of approx. 16,886 sqm between Campos and Santanyi, and offers a mature tree population, ample privacy, and impressive views as far as the Tramuntana mountains. During its construction only the highest-quality materials were used, with the aim of providing maximum comfort. Due to the convenient location various shopping facilities and sandy bays are within easy reach.

A beautiful driveway lined with almond trees leads directly to the property, which immediately impresses with its traditional natural-stone facade.

On the ground floor the impressive entrance hall greets with its 6 metre-high ceiling. Modern fittings combined with Mallorcan architecture and typical island elements to create a warm and timeless character. The pleasant living/dining area with adjoining fireplace room and adjacent, fully-equipped kitchen is flooded with natural light, with wooden ceiling beams and natural stone-clad walls bestow a special ambience upon the rooms. Large sliding glass doors in the living area create an almost seamless transition to the terrace, and there is a separate guest area with a bedroom with en-suite bathroom offering ample privacy.

On the upper floor there are 2 further bedrooms, each with an en suite bathroom, and the spacious master suite. All bedrooms have direct access to a terrace offering beautiful views.

The external area of the finca impresses with its beautiful old trees, and houses the approx. 70 sqm infinity pool with sun terrace and adjoining covered barbecue area.

Further high-quality features include air conditioning, underfloor heating, a heat pump and a 10kw photovoltaic system.

Truly a beautiful oasis of tranquillity offering great exclusivity and maximum comfort!

Campos

search for property MAL-077932



Location & surrounding area:

The rural town of Campos in the South-east of the island is conveniently situated halfway between Lluçmajor and Santanyí. Surrounded by an extensive agricultural area, the town offers many shops for daily needs, restaurants and sporting facilities. There are only a few defence towers left of the old medieval town. Today Campos is a lively community, which especially on market days attracts many visitors.

The famous, long sandy beach of Es Trenc with its dunes and turquoise blue sea belongs to the municipality of Campos and offers beach fun with Caribbean flair.

The airport can be reached in 25 minutes, the island capital Palma is only 35 km away.

Campos

search for property MAL-077932



PORTA MONDIAL®

Your home. Our passion.



Beautiful property



Natural stone walls



Aerial view



Large living room



Bright living room



Living room with fireplace

Campos

search for property MAL-077932



PORTA MONDIAL®

Your home. Our passion.



Modern kitchen



Staircase to the first floor



One of 4 bedrooms



Elegant bathrooms



Beautiful views



Mediterranean garden

Campos

search for property MAL-077932



PORTA MONDIAL®

Your home. Our passion.



Front façade



Entrance gate to the property

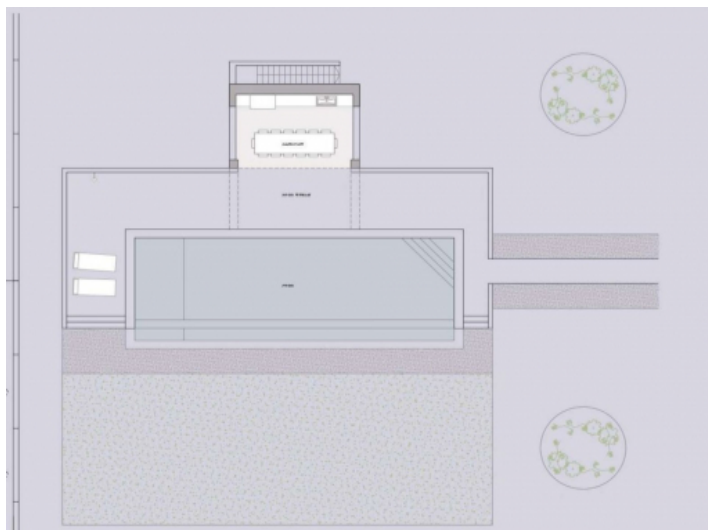

Pool area



Groundfloor



First floor